

STAINLESS STEEL 316L PRESS FIT FITTINGS (M PROFILE)

COMPLY WITH BSEN1254-2:1998
AS 3688:2005
AS/NZS 4020:2005
ASTM E1086:2014
SS 375:2015
SS 270:2015

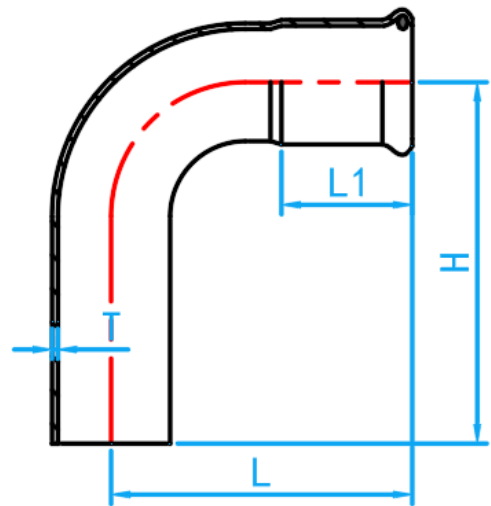

MXF 90° ELBOW



CROSS SECTIONAL VIEW

DIMENSIONS

SKU	SIZE (mm)	L (mm)	L1 (mm)	H (mm)	T (mm)	WEIGHT (kg)	PCS/CTN
SS316LPFNE90015MF	15	41	45	41	1.5	0.042	360
SS316LPFNE90020MF	22	74	62	74	1.5	0.093	150
SS316LPFNE90025MF	28	78	66	78	1.5	0.131	160
SS316LPFNE90035MF	35	241	91	241	1.5	0.212	100
SS316LPFNE90042MF	42	108	98	108	1.5	0.268	60
SS316LPFNE90050MF	54	130	102	130	1.5	0.415	30
SS316LPFNE90065MF	67	150	140	150	2.0	0.800	15
SS316LPFNE90080MF	76	182	160	182	2.0	1.026	12
SS316LPFNE90100MF	108	240	221	240	2.0	2.406	4